



4141 MacArthur Blvd. • Newport Beach, CA 92660  
800-777-0695 • Fax 800-411-9722 • [glidewell.com](http://glidewell.com)

Fill out all applicable criteria on the Rx

Dr. Name \_\_\_\_\_ Phone # \_\_\_\_\_

Patient Name \_\_\_\_\_ Acct. # \_\_\_\_\_  
First Last

Address \_\_\_\_\_

Email \_\_\_\_\_ Deliver by 5 p.m. on [See Reverse for Working Times](#)

Enclosed with case: ☐ Impressions ☐ Models ☐ Bite ☐ Photos ☐ Other: \_\_\_\_\_

### PROVISIONALS SHADE



Indicate Shade Here

### CHOOSE RESTORATION

#### ☐ BioTemps Provisionals

Reinforcement:

- ☐ None ☐ Wire\*\* ☐ Fiber  
☐ Cast-Metal Substructure + 1 working day  
☐ Cement-on Implant #(s) \_\_\_\_\_  
☐ Screw-retained Implant #(s) \_\_\_\_\_

#### ☐ Transition Crowns & Bridges

- Transition C&B are milled from an acetal resin block (No reinforcement)

Fabricate:

- ☐ Lab Prep ☐ Solid Model  
☐ Die-Trim Model  
☐ Cement-on Implant #(s) \_\_\_\_\_  
☐ Screw-retained Implant #(s) \_\_\_\_\_

#### ☐ Smile Transitions

- ☐ Upper ☐ Lower  
☐ Buy 2, same arch only  
☐ Fabricate with occlusal holes  
☐ Open bite \_\_\_\_\_ mm anteriorly  
☐ Add length to gingival on tooth  
#(s) \_\_\_\_\_ by \_\_\_\_\_ mm

TOOTH NUMBER #(s) \_\_\_\_\_ to \_\_\_\_\_

Abutment\*\* #(s) \_\_\_\_\_

Pontic #(s) \_\_\_\_\_

Extract #(s) \_\_\_\_\_

Veneer #(s) \_\_\_\_\_

Splinted\*\* #(s) \_\_\_\_\_

Individual units #(s) \_\_\_\_\_

Amount of Prep Reduction:

- ☐ 1 mm\*\* ☐ 2 mm  
☐ Open Trench #(s) \_\_\_\_\_

### SELECT INCISAL EDGE TYPE



☐ Rounded ☐ Squared ☐ Pointed

### SELECT PONTIC DESIGN TYPE



☐ ☐ ☐ \*\*



☐ ☐

- ☐ Perio treatment: Prepare tooth  
below gingival on  
tooth #(s) \_\_\_\_\_ by \_\_\_\_\_ mm

- ☐ Perio site healing: Prepare ovate socket  
on tooth #(s) \_\_\_\_\_ by \_\_\_\_\_ mm

Rx

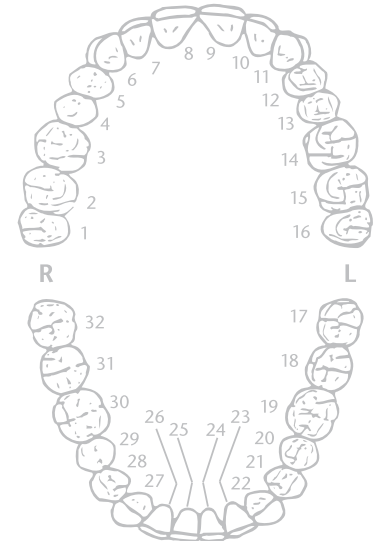

Signature \_\_\_\_\_

License # \_\_\_\_\_ Date \_\_\_\_\_

Submission of this Rx constitutes agreement with limited warranty terms and conditions.  
See reverse for details.

## TERMS AND WARRANTY INFORMATION

We honor VISA, MASTERCARD, AMEX and DISCOVER.

**TERMS:** Cost of collection of any account will be paid by the customer. All accounts are payable within 30 days of statement date. **Accounts not paid within the stated terms will be subject to COD status and a late charge of 2 percent of the unpaid balance.** Prices subject to change without notice. Rx must be enclosed with original case submission.

**NO-FAULT REMAKE POLICY:** Glidewell is pleased to process all remakes or adjustments at no additional charge if requested within the warranty period and **accompanied by the return of the original appliance.**

**LIMITED WARRANTY/LIMITATION OF LIABILITY.** For warranty terms and conditions and limitation of liability, visit [glidewell.com/policies-and-warranties](http://glidewell.com/policies-and-warranties).

- **BioTemps**, 6-month warranty
- **Transition Crowns & Bridges**, 2-year warranty



Please include upper and lower impressions or models and a bite registration. For best results, please do a 'two-step' impression. You may also submit a digital scan. For a detailed process on how to take excellent impressions, scan the QR code to the left.



**All Restorations  
Made in the USA**

## PREPARATION GUIDELINES

### ANTERIOR

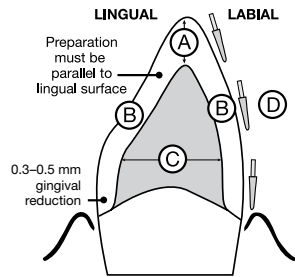

- A. 1 mm incisal reduction
- B. 0.8 mm middle third reduction
- C. Labial and lingual walls must be convergent
- D. Preparation should be cut in three planes

### POSTERIOR

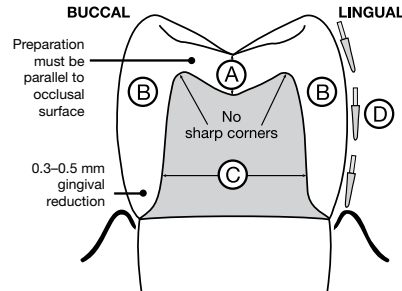

- A. 1 mm occlusal reduction
- B. 0.8 mm middle third reduction
- C. Buccal and lingual walls must be convergent
- D. Preparation should be cut in three planes

### LABIAL OR 360° MARGIN

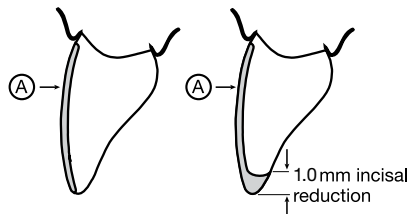

- A. 0.3 to 1.0 mm labial reduction

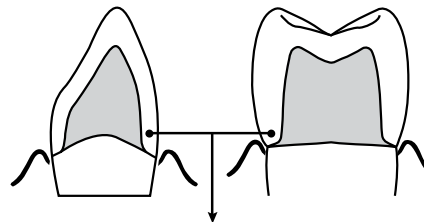

- 0.3-0.5 mm gingival reduction using rounded shoulder margin design

## IN-LAB WORKING TIMES

Please allow full working time for each product selected. Working times are NOT guaranteed and do NOT include weekends or holidays.

<b>BioTemps Provisionals</b> .....	3 working days
w/ cast-metal frame or	
cast-metal reinforcement over implant.....	5 working days
w/ cast-metal substructure.....	5 working days
screw-retained over implant.....	6 working days
<b>Transition Crowns &amp; Bridges</b> .....	6 working days
over implant.....	6 working days
<b>Smile Transitions</b> .....	7 working days

Rush service available. Call for details.

## PROVISIONALS RELINE INSTRUCTIONS

For best results, reline provisionals with a methyl methacrylate acrylic reline material (i.e., Luxatemp® Ultra by DMG America, Jet® by Lang, Coldpac by Yates Motloid or Palavit® 55 by Kulzer). Other reline materials should be avoided. However, if used, mechanical undercuts must be cut into the abutment shells for better retention of the reline material.



- Try in the restorations. If any adjustment is needed to seat the restoration, use a low-speed carbide or composite finishing bur.
- Rinse with water and dry completely.

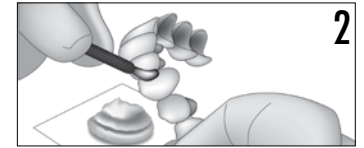

- Apply a thin layer of petroleum jelly to the outer surface of the restoration to prevent excess reline material from sticking.
- Reline provisionals by blocking out any undercuts on the preparations.

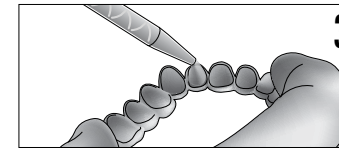

- Apply a minimal amount of reline material to the intaglio of the provisional. Use the mix tip to coat the inner walls with the material and evacuate any trapped air bubbles or voids.
- Do not allow the reline material to fully cure on the preparations due to heat generation, which may cause injury to the pulp.
- Gently work the provisional on and off the preps, allowing them to bench cure.

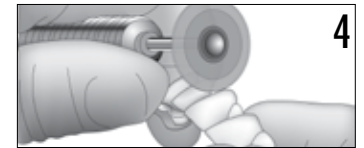

- Trim away any flash or excess acrylic using a plastic grinding disc.
- Provisionals can be polished with pumice and polishing paste or resealed with a light-cured glaze (e.g., Palaseal®, Kulzer).
- Cement provisionals using a non-eugenol temporary cement if higher retention is needed, Neo-Temp™ by Waterpik can be used.